

StreetLight Series



- ▶ **Developed with a lightweight design**
- ▶ **Will work almost everywhere in $\pm 40^{\circ}\text{C}$ ambient temperature**
- ▶ **Advanced LED street lighting technology with excellent stability and high performance**



INTRODUCTION

- Integration of a patented aerospace structural design ensures optimal cooling.
- High stability lighting in any climate thanks to current fluctuation protection.
- Original high-power LED chips, with multiple power supply circuit design options, offer incredible added value.
- PFC values up to 0.99 offering a stable voltage output, thus reducing energy consumption.
- IP68 waterproof standard.
- CRI 70 high-brightness offer much improved night vision to increase pedestrian and vehicle safety.
- LED's emit zero UV or IR waves, no harmful electromagnetic waves, and no detrimental substances (such as mercury) which mean they are safer for the planet AND your street.

SPECIFICATIONS

S02 Series		t25	t50	t75	t100
Power Consumption		25W	50W	75W	100W
Luminaire	○ True White (Max.)	1600	3200	4800	6400
	● Warm White (Max.)	1200	2400	3600	4800
Working Voltage		100~240V AC			
Beam Angle		130 degree			
CRI		70			
Operating Temp		$-40^{\circ}\text{C} \sim +40^{\circ}\text{C}$			

Candle power distribution curve

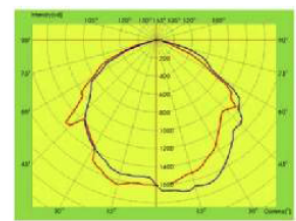
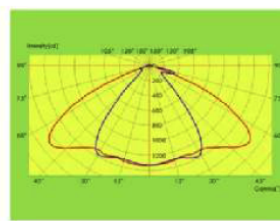

S02 t25

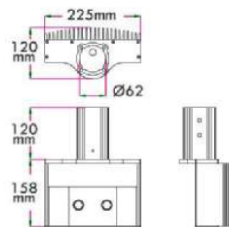

Applicable Pole Dimension :
42~62mm
Weight : 113oz.(3.5KG)

S02 t50 / t75 / t100

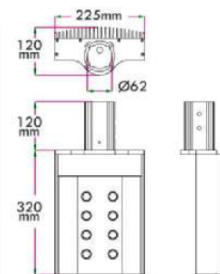

Applicable Pole Dimension :
42~62mm
Weight : 210oz.(6.5KG)